

GLIM NEW

Apparecchio led calpestabile ad incasso per pavimento, terreno o parete, indicato per luce d'accento o di segnalazione. Corpo in alluminio tornito e ossidato con trattamento anticorrosione colore nero. Cornice in alluminio verniciato bianco, silver, grigio, corten, antracite o in acciaio inox AISI316. Ottica con lente in PMMA ad alto rendimento di flusso. Diffusore in vetro temperato extrachiaro tornito spessore 3 mm. Disponibile in versione rotonda o quadrata da una a quattro finestre di luce.

Walkable LED recessed luminaire for floor, ground or wall, suitable for accent or signal lighting. Turned oxidized aluminum body with black anti-corrosion treatment. Aluminium frame painted white, gray, anthracite, or AISI316 stainless steel. Optic with PMMA lens with high luminous flux. Diffuser in turned extraclear tempered glass thickness 3 mm. Available in round or square versions with one to four light apertures.

CARATTERISTICHE / MAIN FEATURES

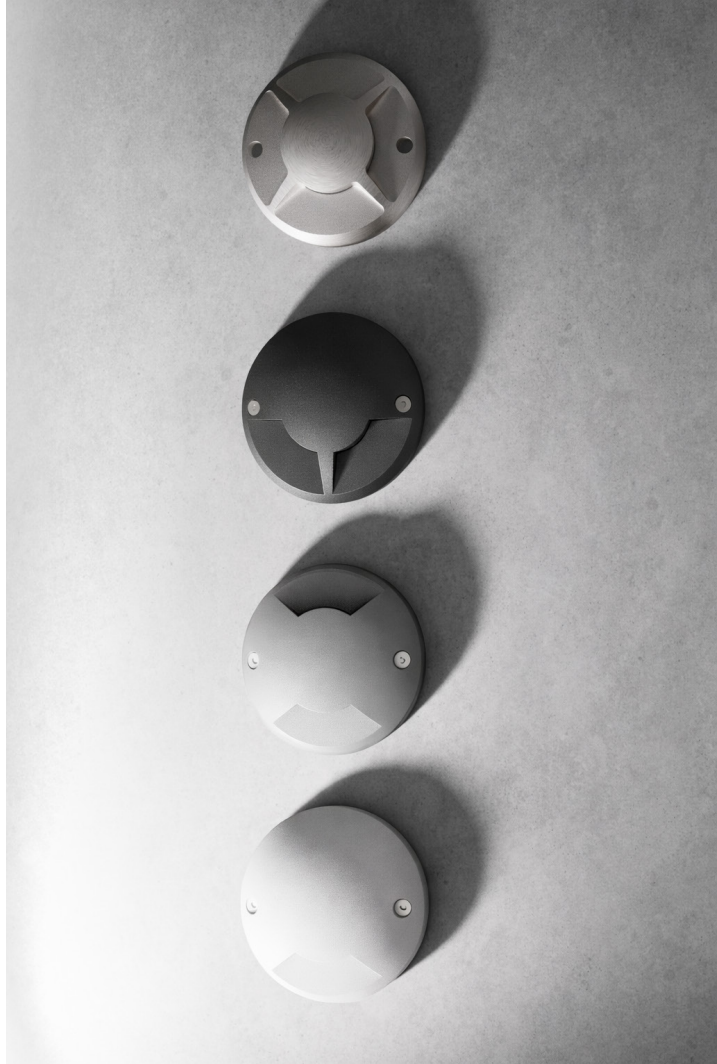

CODIFICA CODICE / CODING

Art.	+	Mod.	+	°K (CRI)	+	W. tot.	+	Options	
7071		R51 R91		97 = 2700°K (CRI ≥90) *		02		BL = on/off	○ Bianco / White
		R52 R92		93 = 3000°K (CRI ≥90)		05		SL = on/off	○ Silver / Silver
		R54 R94		94 = 4000°K (CRI ≥90)				GL = on/off	● Grigio / Grey
		R58 R98						CL = on/off	● Corten / Corten
		Q51 Q91						NL = on/off	● Antracite / Anthracite
		Q52 Q92						AX = on/off	○ Acciaio inox AISI 316 / Stainless steel AISI 316
		Q54 Q94							

* disponibilità su richiesta / * available on request

Δ LUMEN

	°K	CRI	% Lm
97	2700	≥ 90	-13.68%
93	3000	≥ 90	-7.37%
94	4000	≥ 90	standard

DOTAZIONE / STANDARD EQUIPMENT

- Pressacavo PG7 con acquastop integrato.
- Cavo H05RN-F da 500mm incluso.
- PG7 cable gland with integrated water stop.
- 500mm H05RN-F cable included.

INSTALLAZIONE / INSTALLATION

Apparecchio per installazione ad incasso in pavimentazione o terreno, idoneo al collegamento elettrico mediante posa diretta in tubo corrugato.

Recessed floor or ground fixture, suitable for electrical connection via direct installation in corrugated pipe.



Mod. R51

Ottica

Ottica con lente in PMMA ad alto rendimento di flusso, antiabbagliamento ed antiriflesso. Diffusore in vetro tornito temperato extrachiaro spessore 3 mm. Singola finestra di luce con distribuzione a 90°.

Corpo

Corpo in alluminio tornito ossidato colore nero. Cornice in alluminio verniciato bianco, silver, grigio, corten, antracite o in acciaio inox AISI316.

Optic

Optic with PMMA lens with high flux efficiency, anti-glare and anti-reflection. Turned extra-clear tempered glass diffuser, thickness 3 mm. Single light window with 90° distribution.

Body

Black turned oxidized aluminum body. Aluminium frame painted white, silver, gray, corten, anthracite, or AISI316 stainless steel.

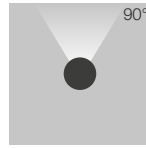
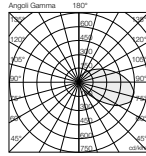

ESEMPIO CODIFICA CODICE 4000K - CRI \geq 90 - ON/OFF

E.G. ARTICLE REFERENCE 4000K - CRI \geq 90 - ON/OFF

Code	W	°K	CRI	Lm OUTPUT	ØxH (mm)	Col.
7071R519402BL	2	4000	≥90	28	50 x 46	○
7071R519402SL	2	4000	≥90	28	50 x 46	●
7071R519402GL	2	4000	≥90	28	50 x 46	●
7071R519402CL	2	4000	≥90	28	50 x 46	●
7071R519402NL	2	4000	≥90	28	50 x 46	●
7071R519402AX	2	4000	≥90	28	50 x 46	○

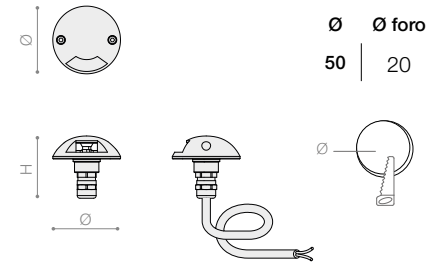

Mod. R52

Ottica

Ottica con lente in PMMA ad alto rendimento di flusso, antiabbagliamento ed antiriflesso. Diffusore in vetro tornito temperato extrachiaro spessore 3 mm. Doppia finestra di luce contrapposta con distribuzione di luce a 180°.

Corpo

Corpo in alluminio tornito ossidato colore nero. Cornice in alluminio verniciato bianco, silver, grigio, corten, antracite o in acciaio inox AISI316.

Optic

Optic with PMMA lens with high flux efficiency, anti-glare and anti-reflection. Turned extra-clear tempered glass diffuser, thickness 3 mm. Double window of opposing light with 180° distribution.

Body

Black turned oxidized aluminum body. Aluminium frame painted white, silver, gray, corten, anthracite, or AISI316 stainless steel.

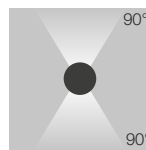
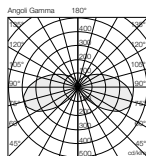

ESEMPIO CODIFICA CODICE 4000K - CRI \geq 90 - ON/OFF

E.G. ARTICLE REFERENCE 4000K - CRI \geq 90 - ON/OFF

Code	W	°K	CRI	Lm OUTPUT	ØxH (mm)	Col.
7071R529402BL	2	4000	≥90	48	50 x 46	○
7071R529402SL	2	4000	≥90	48	50 x 46	●
7071R529402GL	2	4000	≥90	48	50 x 46	●
7071R529402CL	2	4000	≥90	48	50 x 46	●
7071R529402NL	2	4000	≥90	48	50 x 46	●
7071R529402AX	2	4000	≥90	48	50 x 46	○

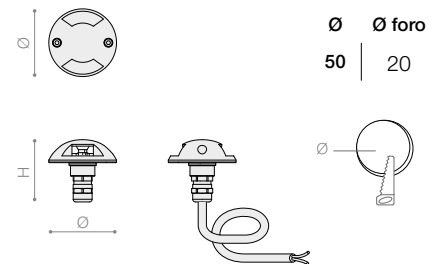

Mod. R54

Ottica

Ottica con lente in PMMA ad alto rendimento di flusso, antiabbagliamento ed antiriflesso. Diffusore in vetro tornito temperato extrachiaro spessore 3 mm. Quattro finestre di luce con distribuzione di luce a 360°.

Corpo

Corpo in alluminio tornito ossidato colore nero. Cornice in alluminio verniciato bianco, silver, grigio, corten, antracite o in acciaio inox AISI316.

Optic

Optic with PMMA lens with high flux efficiency, anti-glare and anti-reflection. Turned extra-clear tempered glass diffuser, thickness 3 mm. Four windows of light with 360° distribution.

Body

Black turned oxidized aluminum body. Aluminium frame painted white, silver, gray, corten, anthracite, or AISI316 stainless steel.

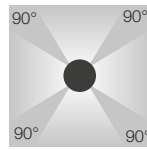
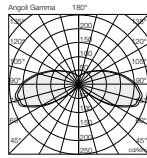

ESEMPIO CODIFICA CODICE 4000K - CRI≥90 - ON/OFF

E.G. ARTICLE REFERENCE 4000K - CRI≥90 - ON/OFF

Code	W	°K	CRI	Lm OUTPUT	ØxH (mm)	Col.
7071R549402BL	2	4000	≥90	88	50 x 46	○
7071R549402SL	2	4000	≥90	88	50 x 46	●
7071R549402GL	2	4000	≥90	88	50 x 46	●
7071R549402CL	2	4000	≥90	88	50 x 46	●
7071R549402NL	2	4000	≥90	88	50 x 46	●
7071R549402AX	2	4000	≥90	88	50 x 46	○

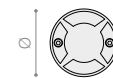

Ø 50 | Ø foro 20

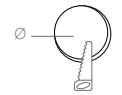
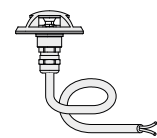
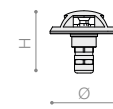

Mod. R58

Ottica

Ottica con lente in PMMA ad alto rendimento di flusso, antiabbagliamento ed antiriflesso. Diffusore in vetro tornito temperato extrachiaro spessore 3 mm. Doppia finestra di luce a con distribuzione di luce a 180°.

Corpo

Corpo in alluminio tornito ossidato colore nero. Cornice in alluminio verniciato bianco, silver, grigio, corten, antracite o in acciaio inox AISI316.

Optic

Optic with PMMA lens with high flux efficiency, anti-glare and anti-reflection. Turned extra-clear tempered glass diffuser, thickness 3 mm. Double windows of light with 180° distribution.

Body

Black turned oxidized aluminum body. Aluminium frame painted white, silver, gray, corten, anthracite, or AISI316 stainless steel.

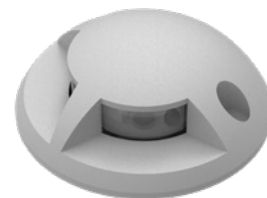
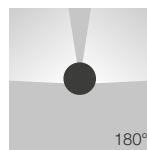
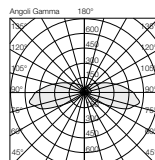

ESEMPIO CODIFICA CODICE 4000K - CRI≥90 - ON/OFF

E.G. ARTICLE REFERENCE 4000K - CRI≥90 - ON/OFF

Code	W	°K	CRI	Lm OUTPUT	ØxH (mm)	Col.
7071R589402BL	2	4000	≥90	40	50 x 46	○
7071R589402SL	2	4000	≥90	40	50 x 46	●
7071R589402GL	2	4000	≥90	40	50 x 46	●
7071R589402CL	2	4000	≥90	40	50 x 46	●
7071R589402NL	2	4000	≥90	40	50 x 46	●
7071R589402AX	2	4000	≥90	40	50 x 46	○

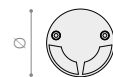

Ø 50 | Ø foro 20

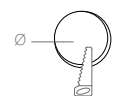
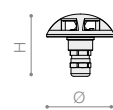

Mod. Q51

Ottica

Ottica con lente in PMMA ad alto rendimento di flusso, antiabbagliamento ed antiriflesso. Diffusore in vetro tornito temperato extrachiario spessore 3 mm. Singola finestra di luce con distribuzione a 90°.

Corpo

Corpo in alluminio tornito ossidato colore nero. Cornice in alluminio verniciato bianco, silver, grigio, corten, antracite o in acciaio inox AISI316.

Optic

Optic with PMMA lens with high flux efficiency, anti-glare and anti-reflection. Turned extra-clear tempered glass diffuser, thickness 3 mm. Single light window with 90° distribution.

Body

Black turned oxidized aluminum body. Aluminium frame painted white, silver, gray, corten, anthracite, or AISI316 stainless steel.

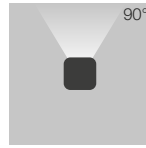
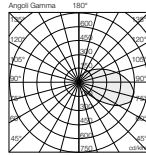

ESEMPIO CODIFICA CODICE 4000K - CRI≥90 - ON/OFF

E.G. ARTICLE REFERENCE 4000K - CRI≥90 - ON/OFF

Code	W	°K	CRI	Lm OUTPUT	LxPxH (mm)	Col.
7071Q519402BL	2	4000	≥90	28	50 x 50 x 46	○
7071Q519402SL	2	4000	≥90	28	50 x 50 x 46	●
7071Q519402GL	2	4000	≥90	28	50 x 50 x 46	●
7071Q519402CL	2	4000	≥90	28	50 x 50 x 46	●
7071Q519402NL	2	4000	≥90	28	50 x 50 x 46	●
7071Q519402AX	2	4000	≥90	28	50 x 50 x 46	○

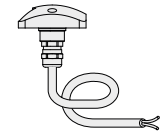
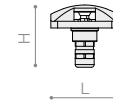
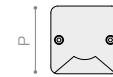

Ø 50 | Ø foro 20

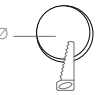

AFCH - ESTERNO

Mod. Q52

Ottica

Ottica con lente in PMMA ad alto rendimento di flusso, antiabbagliamento ed antiriflesso. Diffusore in vetro tornito temperato extrachiario spessore 3 mm. Doppia finestra di luce contrapposta con distribuzione di luce a 180°.

Corpo

Corpo in alluminio tornito ossidato colore nero. Cornice in alluminio verniciato bianco, silver, grigio, corten, antracite o in acciaio inox AISI316.

Optic

Optic with PMMA lens with high flux efficiency, anti-glare and anti-reflection. Turned extra-clear tempered glass diffuser, thickness 3 mm. Double window of opposing light with 180° distribution.

Body

Black turned oxidized aluminum body. Aluminium frame painted white, silver, gray, corten, anthracite, or AISI316 stainless steel.

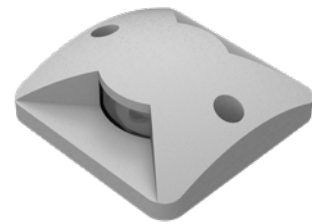
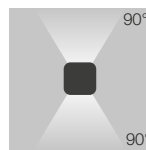
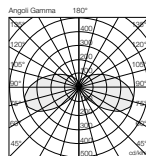

ESEMPIO CODIFICA CODICE 4000K - CRI≥90 - ON/OFF

E.G. ARTICLE REFERENCE 4000K - CRI≥90 - ON/OFF

Code	W	°K	CRI	Lm OUTPUT	LxPxH (mm)	Col.
7071Q529402BL	2	4000	≥90	48	50 x 50 x 46	○
7071Q529402SL	2	4000	≥90	48	50 x 50 x 46	●
7071Q529402GL	2	4000	≥90	48	50 x 50 x 46	●
7071Q529402CL	2	4000	≥90	48	50 x 50 x 46	●
7071Q529402NL	2	4000	≥90	48	50 x 50 x 46	●
7071Q529402AX	2	4000	≥90	48	50 x 50 x 46	○

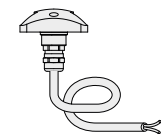
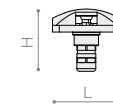
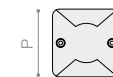

Ø 50 | Ø foro 20

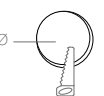

Mod. Q54

Ottica

Ottica con lente in PMMA ad alto rendimento di flusso, antiabbagliamento ed antiriflesso. Diffusore in vetro tornito temperato extrachiaro spessore 3 mm. Quattro finestre di luce con distribuzione di luce a 360°.

Corpo

Corpo in alluminio tornito ossidato colore nero. Cornice in alluminio verniciato bianco, silver, grigio, corten, antracite o in acciaio inox AISI316.

Optic

Optic with PMMA lens with high flux efficiency, anti-glare and anti-reflection. Turned extra-clear tempered glass diffuser, thickness 3 mm. Four windows of light with 360° distribution.

Body

Black turned oxidized aluminum body. Aluminium frame painted white, silver, gray, corten, anthracite, or AISI316 stainless steel.

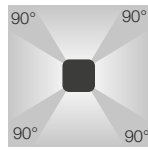
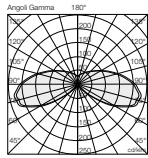

ESEMPIO CODIFICA CODICE 4000K - CRI≥90 - ON/OFF

E.G. ARTICLE REFERENCE 4000K - CRI≥90 - ON/OFF

Code	W	°K	CRI	Lm OUTPUT	LxPxH (mm)	Col.
7071Q549402BL	2	4000	≥90	88	50 x 50 x 46	○
7071Q549402SL	2	4000	≥90	88	50 x 50 x 46	●
7071Q549402GL	2	4000	≥90	88	50 x 50 x 46	●
7071Q549402CL	2	4000	≥90	88	50 x 50 x 46	●
7071Q549402NL	2	4000	≥90	88	50 x 50 x 46	●
7071Q549402AX	2	4000	≥90	88	50 x 50 x 46	○

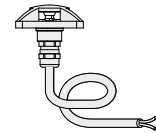
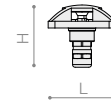

Ø Ø foro
50 | 20

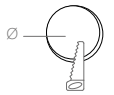

Mod. R91

Ottica

Ottica con lente in PMMA ad alto rendimento di flusso, antiabbagliamento ed antiriflesso. Diffusore in vetro tornito temperato extrachiaro spessore 3 mm. Singola finestra di luce con distribuzione a 90°.

Corpo

Corpo in alluminio tornito ossidato colore nero. Cornice in alluminio verniciato bianco, silver, grigio, corten, antracite o in acciaio inox AISI316.

Optic

Optic with PMMA lens with high flux efficiency, anti-glare and anti-reflection. Turned extra-clear tempered glass diffuser, thickness 3 mm. Single light window with 90° distribution.

Body

Black turned oxidized aluminum body. Aluminium frame painted white, silver, gray, corten, anthracite, or AISI316 stainless steel.

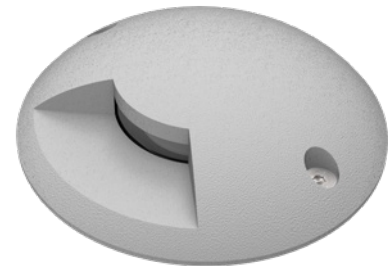
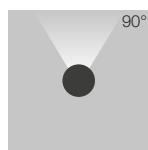
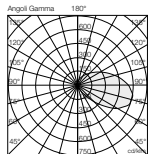

ESEMPIO CODIFICA CODICE 4000K - CRI≥90 - ON/OFF

E.G. ARTICLE REFERENCE 4000K - CRI≥90 - ON/OFF

Code	W	°K	CRI	Lm OUTPUT	ØxH (mm)	Col.
7071R919405BL	5	4000	≥90	48	100 x 52	○
7071R919405SL	5	4000	≥90	48	100 x 52	●
7071R919405GL	5	4000	≥90	48	100 x 52	●
7071R919405CL	5	4000	≥90	48	100 x 52	●
7071R919405NL	5	4000	≥90	48	100 x 52	●
7071R919405AX	5	4000	≥90	48	100 x 52	○

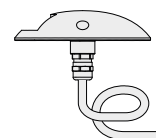
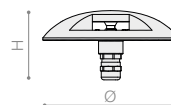
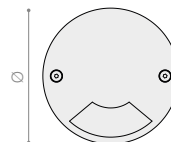

Ø Ø foro
100 | 20

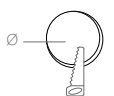

Mod. R92

Ottica

Ottica con lente in PMMA ad alto rendimento di flusso, antiabbagliamento ed antiriflesso. Diffusore in vetro tornito temperato extrachiario spessore 3 mm. Doppia finestra di luce contrapposta con distribuzione di luce a 180°.

Corpo

Corpo in alluminio tornito ossidato colore nero. Cornice in alluminio verniciato bianco, silver, grigio, corten, antracite o in acciaio inox AISI316.

Optic

Optic with PMMA lens with high flux efficiency, anti-glare and anti-reflection. Turned extra-clear tempered glass diffuser, thickness 3 mm. Double window of opposing light with 180° distribution.

Body

Black turned oxidized aluminum body. Aluminium frame painted white, silver, gray, corten, anthracite, or AISI316 stainless steel.

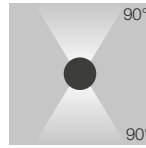
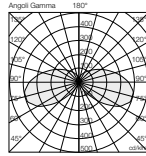

ESEMPIO CODIFICA CODICE 4000K - CRI \geq 90 - ON/OFF

E.G. ARTICLE REFERENCE 4000K - CRI \geq 90 - ON/OFF

Code	W	°K	CRI	Lm OUTPUT	ØxH (mm)	Col.
7071R929405BL	5	4000	≥90	108	100 x 52	○
7071R929405SL	5	4000	≥90	108	100 x 52	●
7071R929405GL	5	4000	≥90	108	100 x 52	●
7071R929405CL	5	4000	≥90	108	100 x 52	●
7071R929405NL	5	4000	≥90	108	100 x 52	●
7071R929405AX	5	4000	≥90	108	100 x 52	○

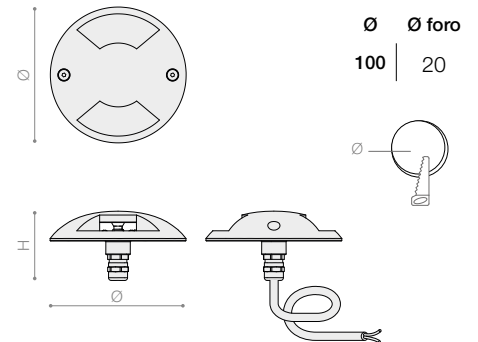

Mod. R94

Ottica

Ottica con lente in PMMA ad alto rendimento di flusso, antiabbagliamento ed antiriflesso. Diffusore in vetro tornito temperato extrachiario spessore 3 mm. Quattro finestre di luce con distribuzione di luce a 360°.

Corpo

Corpo in alluminio tornito ossidato colore nero. Cornice in alluminio verniciato bianco, silver, grigio, corten, antracite o in acciaio inox AISI316.

Optic

Optic with PMMA lens with high flux efficiency, anti-glare and anti-reflection. Turned extra-clear tempered glass diffuser, thickness 3 mm. Four windows of light with 360° distribution.

Body

Black turned oxidized aluminum body. Aluminium frame painted white, silver, gray, corten, anthracite, or AISI316 stainless steel.

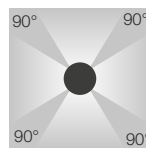
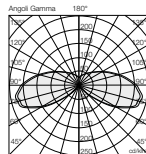

ESEMPIO CODIFICA CODICE 4000K - CRI \geq 90 - ON/OFF

E.G. ARTICLE REFERENCE 4000K - CRI \geq 90 - ON/OFF

Code	W	°K	CRI	Lm OUTPUT	ØxH (mm)	Col.
7071R949405BL	5	4000	≥90	208	100 x 52	○
7071R949405SL	5	4000	≥90	208	100 x 52	●
7071R949405GL	5	4000	≥90	208	100 x 52	●
7071R949405CL	5	4000	≥90	208	100 x 52	●
7071R949405NL	5	4000	≥90	208	100 x 52	●
7071R949405AX	5	4000	≥90	208	100 x 52	○

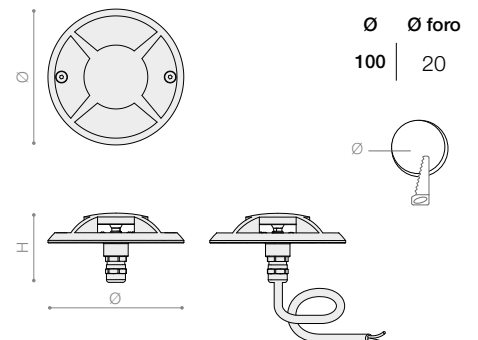

Mod. R98

Ottica

Ottica con lente in PMMA ad alto rendimento di flusso, antiabbagliamento ed antiriflesso. Diffusore in vetro tornito temperato extrachiaro spessore 3 mm. Doppia finestra di luce a con distribuzione di luce a 180°.

Corpo

Corpo in alluminio tornito ossidato colore nero. Cornice in alluminio verniciato bianco, silver, grigio, corten, antracite o in acciaio inox AISI316.

Optic

Optic with PMMA lens with high flux efficiency, anti-glare and anti-reflection. Turned extra-clear tempered glass diffuser, thickness 3 mm. Double windows of light with 180° distribution.

Body

Black turned oxidized aluminum body. Aluminium frame painted white, silver, gray, corten, anthracite, or AISI316 stainless steel.

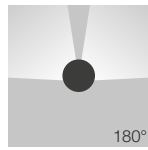
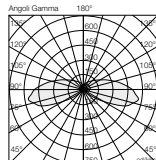

ESEMPIO CODIFICA CODICE 4000K - CRI≥90 - ON/OFF

E.G. ARTICLE REFERENCE 4000K - CRI≥90 - ON/OFF

Code	W	°K	CRI	Lm OUTPUT	ØxH (mm)	Col.
7071R989405BL	5	4000	≥90	96	100 x 52	○
7071R989405SL	5	4000	≥90	96	100 x 52	●
7071R989405GL	5	4000	≥90	96	100 x 52	●
7071R989405CL	5	4000	≥90	96	100 x 52	●
7071R989405NL	5	4000	≥90	96	100 x 52	●
7071R989405AX	5	4000	≥90	96	100 x 52	○

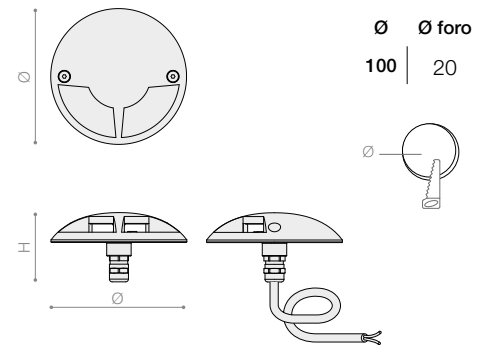

Mod. Q91

Ottica

Ottica con lente in PMMA ad alto rendimento di flusso, antiabbagliamento ed antiriflesso. Diffusore in vetro tornito temperato extrachiaro spessore 3 mm. Singola finestra di luce con distribuzione a 90°.

Corpo

Corpo in alluminio tornito ossidato colore nero. Cornice in alluminio verniciato bianco, silver, grigio, corten, antracite o in acciaio inox AISI316.

Optic

Optic with PMMA lens with high flux efficiency, anti-glare and anti-reflection. Turned extra-clear tempered glass diffuser, thickness 3 mm. Single light window with 90° distribution.

Body

Black turned oxidized aluminum body. Aluminium frame painted white, silver, gray, corten, anthracite, or AISI316 stainless steel.

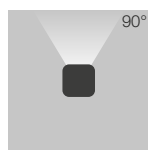
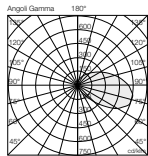

ESEMPIO CODIFICA CODICE 4000K - CRI≥90 - ON/OFF

E.G. ARTICLE REFERENCE 4000K - CRI≥90 - ON/OFF

Code	W	°K	CRI	Lm OUTPUT	LxPxH (mm)	Col.
7071Q919405BL	5	4000	≥90	48	100 x 100 x 52	○
7071Q919405SL	5	4000	≥90	48	100 x 100 x 52	●
7071Q919405GL	5	4000	≥90	48	100 x 100 x 52	●
7071Q919405CL	5	4000	≥90	48	100 x 100 x 52	●
7071Q919405NL	5	4000	≥90	48	100 x 100 x 52	●
7071Q919405AX	5	4000	≥90	48	100 x 100 x 52	○

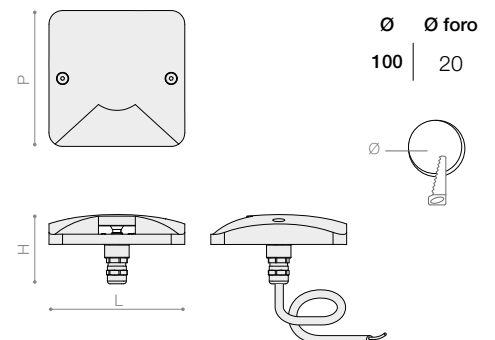

Mod. Q92

Ottica

Ottica con lente in PMMA ad alto rendimento di flusso, antiabbagliamento ed antiriflesso. Diffusore in vetro tornito temperato extrachiaro spessore 3 mm. Doppia finestra di luce contrapposta con distribuzione di luce a 180°.

Corpo

Corpo in alluminio tornito ossidato colore nero. Cornice in alluminio verniciato bianco, silver, grigio, corten, antracite o in acciaio inox AISI316.

Optic

Optic with PMMA lens with high flux efficiency, anti-glare and anti-reflection. Turned extra-clear tempered glass diffuser, thickness 3 mm. Double window of opposing light with 180° distribution.

Body

Black turned oxidized aluminum body. Aluminium frame painted white, silver, gray, corten, anthracite, or AISI316 stainless steel.

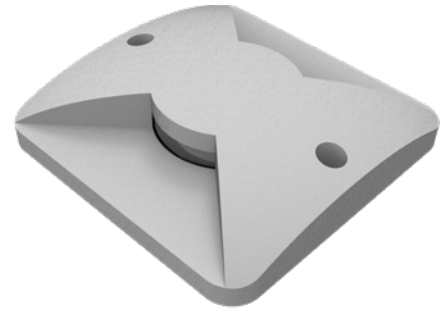
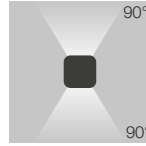
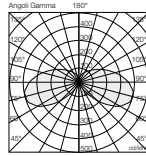

ESEMPIO CODIFICA CODICE 4000K - CRI \geq 90 - ON/OFF

E.G. ARTICLE REFERENCE 4000K - CRI \geq 90 - ON/OFF

Code	W	°K	CRI	Lm OUTPUT	LxPxH (mm)	Col.
7071Q929405BL	5	4000	\geq 90	108	100 x 100 x 52	○
7071Q929405SL	5	4000	\geq 90	108	100 x 100 x 52	●
7071Q929405GL	5	4000	\geq 90	108	100 x 100 x 52	●
7071Q929405CL	5	4000	\geq 90	108	100 x 100 x 52	●
7071Q929405NL	5	4000	\geq 90	108	100 x 100 x 52	●
7071Q929405AX	5	4000	\geq 90	108	100 x 100 x 52	○

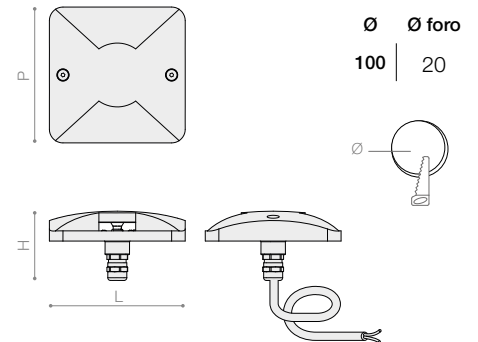

Mod. Q94

Ottica

Ottica con lente in PMMA ad alto rendimento di flusso, antiabbagliamento ed antiriflesso. Diffusore in vetro tornito temperato extrachiaro spessore 3 mm. Quattro finestre di luce con distribuzione di luce a 360°.

Corpo

Corpo in alluminio tornito ossidato colore nero. Cornice in alluminio verniciato bianco, silver, grigio, corten, antracite o in acciaio inox AISI316.

Optic

Optic with PMMA lens with high flux efficiency, anti-glare and anti-reflection. Turned extra-clear tempered glass diffuser, thickness 3 mm. Four windows of light with 360° distribution.

Body

Black turned oxidized aluminum body. Aluminium frame painted white, silver, gray, corten, anthracite, or AISI316 stainless steel.

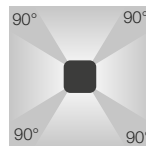
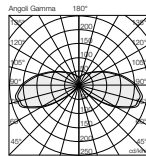

ESEMPIO CODIFICA CODICE 4000K - CRI \geq 90 - ON/OFF

E.G. ARTICLE REFERENCE 4000K - CRI \geq 90 - ON/OFF

Code	W	°K	CRI	Lm OUTPUT	LxPxH (mm)	Col.
7071Q949405BL	5	4000	\geq 90	208	100 x 100 x 52	○
7071Q949405SL	5	4000	\geq 90	208	100 x 100 x 52	●
7071Q949405GL	5	4000	\geq 90	208	100 x 100 x 52	●
7071Q949405CL	5	4000	\geq 90	208	100 x 100 x 52	●
7071Q949405NL	5	4000	\geq 90	208	100 x 100 x 52	●
7071Q949405AX	5	4000	\geq 90	208	100 x 100 x 52	○

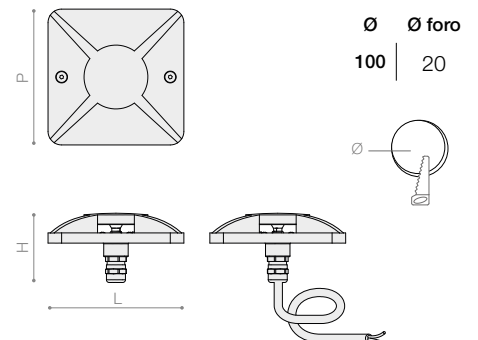



ACC362



ACC363



ACC364



ACC365



ACC366



ACC367



ACC368



ACC369

ACC362 Driver remoto 24V 30W IP20.
Remote driver 24V 30W IP20.

ACC363 Driver remoto 24V 75W IP20.
Remote driver 24V 75W IP20.

ACC364 Driver remoto 24V 75W IP67.
Remote driver 24V 75W IP67.

ACC365 Driver remoto DALI 24V 100W IP67.
Remote DALI driver 24V 100W IP67.

ACC366 Cavo H05RN-F 2x0,75 mm² lunghezza 5m.
H05RN-F 2x0.75 mm² cable length 5m.

ACC367 Cavo H05RN-F 2x0,75 mm² lunghezza 10m.
H05RN-F 2x0.75 mm² cable length 10m.

ACC368 Cavo H05RN-F 2x0,75 mm² lunghezza 15m.
H05RN-F 2x0.75 mm² cable length 15m.

ACC369 Cavo H05RN-F 2x0,75 mm² lunghezza 20m.
H05RN-F 2x0.75 mm² cable length 20m.

